

Ashland Community & Technical College Daycare Facility Parking Lot Aerial/Topographic As-Built Survey Ashland, Kentucky

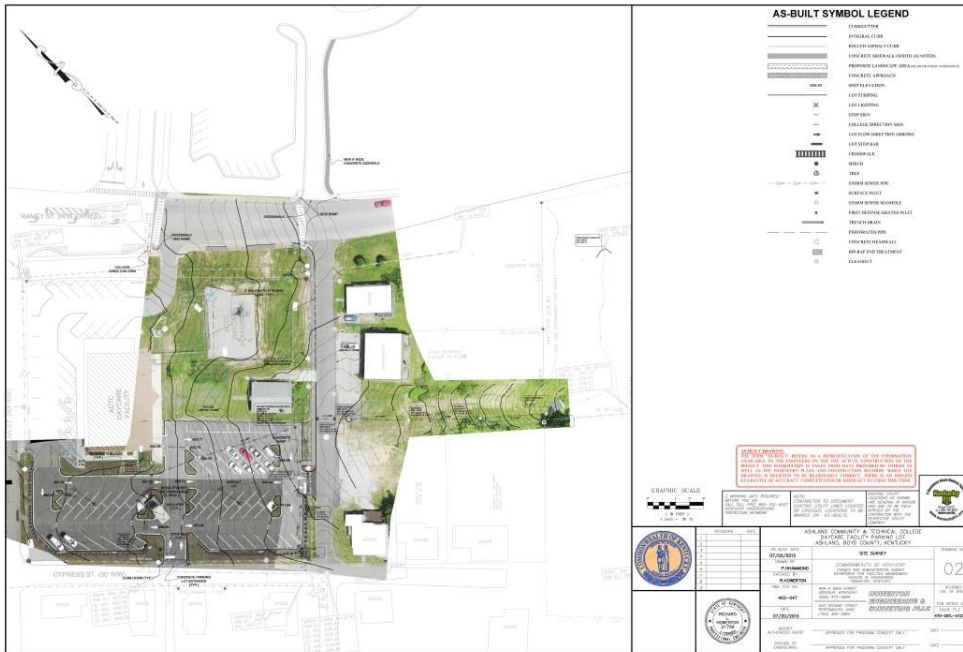

Client/Location

ACTC
1400 College Drive
Ashland, KY 41101
800-928-4256

Client Reference

John Morgan
Commonwealth of KY
Div. of Engineering &
Contract Admin.
502-782-0320
Josh.morgan@ky.gov

Project Status

Complete

Dates of Service

2015

Special Features

- Plan/Profile
- Topographic Survey
- Drone Orthos
- Aerial Survey
- Aerial Photography Overlay

Project Description

Howerton Engineering & Surveying was contracted by The Commonwealth of Kentucky to perform the initial boundary and topographic survey for the proposed Daycare Facility Parking Lot project. HES designed the proposed parking lot and was built in 2014.

Howerton Engineering & Surveying performed an Aerial survey of the new Daycare Facility Parking Lot along with GPS topographic survey. The new storm sewer infrastructure was mapped and the state was presented with a full set of plan/profiles of the new facility; along with CAD dwg files to add to their ACTC master plan.

