

American Electric Power Plan/Profile of Wire Crossing US 23 at The Big Sandy Power Plant Lawrence County, Kentucky

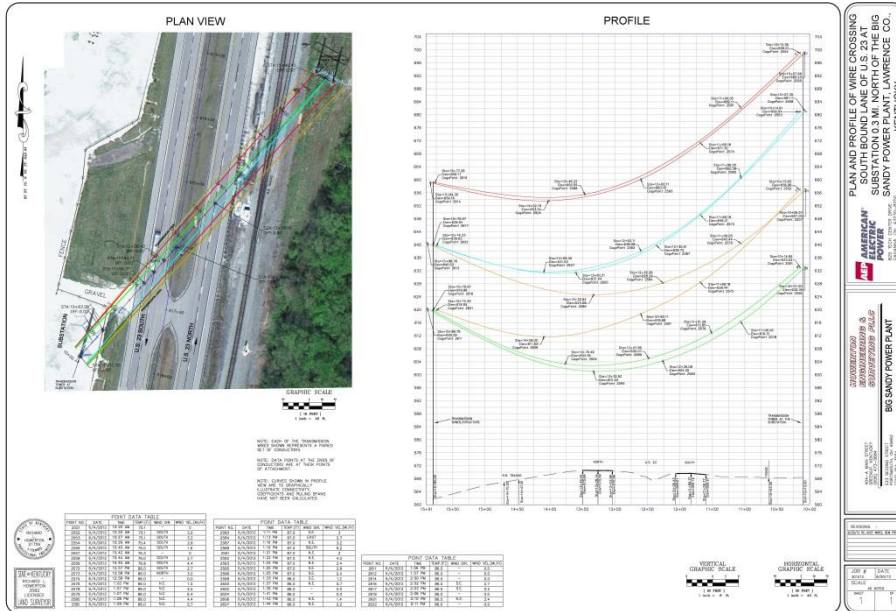

Client/Location

AEP
700 Morrison Road
Gahanna, OH 43230

Client Reference

Ed Gilbert, PMP
Big Sandy FGD
Project Manager
(614) 716-1765

Project Status

Complete

Dates of Service

2012

Special Features

- Plan/Profile
- Boundary Survey
- Right of Way Survey
- Aerial Photography Overlay

Project Description

Howerton Engineering & Surveying was contracted by American Electric Power to locate aerial lines crossing starting at the ARCH Coal Facility located just south of I-64 near Catlettsburg, KY and traversing south on U.S. Route 23 to the entrance at the Big Sandy Power Plant in Lawrence County.

The path of the alignment was approximately 12 miles and consisted of over 50 aerial crossings. Both horizontal and vertical locations of each line along with the sag was located and mapped.

