

The City of Flatwoods State Route 750 (Powell Lane) Right of Way Survey Flatwoods, Kentucky

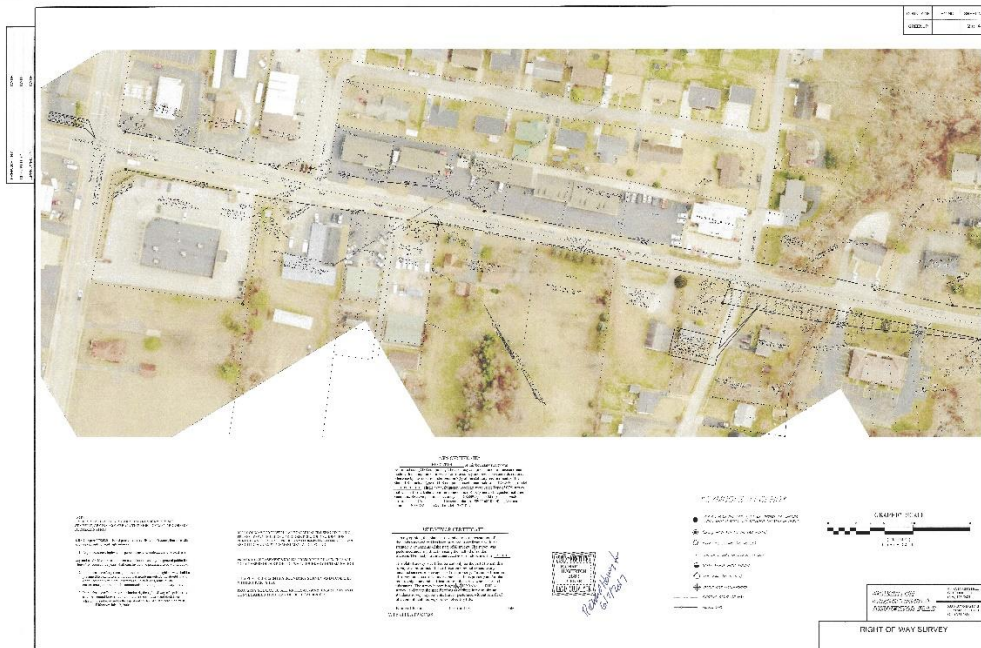

Client/Location

The City of Flatwoods
2513 Reed Street
Flatwoods, KY 41139

Client Reference

Mayor Ron Fields
City of Flatwoods
2513 Reed Street
Flatwoods, KY 41139
rfields@flatwoodsky.org

Project Status

Complete

Dates of Service

2017

Special Features

- Right of Way Survey
- Highway Monumentation
- ROW Determination
- KYTC Highway Maps
- Centerline Data Collection

Project Description

Howerton Engineering & Surveying was contracted by The City of Flatwoods to perform a Right-of-Way survey along State Route 750 (Powell Lane) from Kentucky Route 207 to Seaton Avenue, located within The City of Flatwoods.

The first phase of the project was to obtain Kentucky State Highway maps for State Route 207 and State Route 750. An initial survey was performed to search for existing right of way monuments and to obtain existing centerline road data. Upon recovering existing monuments and surveying, Howerton Engineering & Surveying was able to determine the location of the existing right of way along State Route 750.

The next phase of the project was to set right of way monumentation in accordance with KYTC Standards along State Route 750.

A final plat and legal description of the right of way was overlaid on aerial photography and delivered to The City of Flatwoods for recording.